

Job Aid: DWAPI Installation, Configuration and Navigation (Windows)

Applies to: DWAPI 2.7.1, Win OS

Revised: August 2021

Tasks: How to Install, Configure and Load Data using DWAPI

Who: HIS user

Pre-requisites: Microsoft .NET Framework runtime 2.1, Access to an EMR server and Win OS, Internet connectivity

Step	Action	Screen Shot
1.	<p>Download DWAPI and .NET Core 2.1</p> <ul style="list-style-type: none"> Download NetCore Runtime that matches your PC (X86-32bit, x64-64bit) Double Click downloaded installer to execute Click on dotnet-sdk-2.1.400win-x64.exe and the following screen will appear 	 <p>Dwapi for Windows Instruction</p> <ol style="list-style-type: none"> 1. Install prerequisite(NetCore Runtime) https://www.microsoft.com/net/download/dotnet-core/2.1 2. Install DWAPI http://data.kenyahmis.org:81/dwapi/client/downloads/dwapi.exe

2.	<p>Install .NET Core 2.1</p> <ul style="list-style-type: none"> Click on Install Once installation is complete and successful you will receive following message Click to Close when done 	 <p>Microsoft .NET Core SDK 2.1.400 (x64) Installer</p> <p>Microsoft .NET Core SDK 2.1.400</p> <p>.NET Core SDK .NET Core is a development platform that you can use to build command-line applications, microservices and modern websites. It is open source, cross-platform, and supported by Microsoft. We hope you enjoy it!</p> <p>Learn more about .NET Core</p> <ul style="list-style-type: none"> Core Documentation SDK Documentation Privacy Statement MIT License <p>Installation note A command will be run during the install process that will improve project restore speed and enable offline access. It will take up to a minute to complete. If you plan to use .NET Core 2.1 with Visual Studio, Visual Studio 2017 15.7 or newer is recommended. Learn More.</p> <p>Install Close</p>
----	---	---

3. **Install DWAPI**

- Click on **Dwapi.exe** if you are connected to the Internet and there is a new version available you will be prompted to download it.
- Once complete you will get the screen prompt
- Click on NEXT and ensure the installation folder is *C:\Program Files (x86)\Palladium Group\Dwapi*

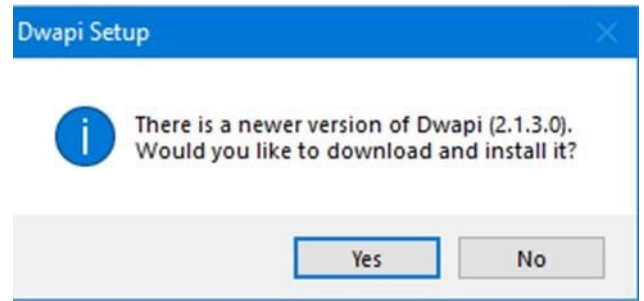

- Click Next then Click Install
- Once complete click finish

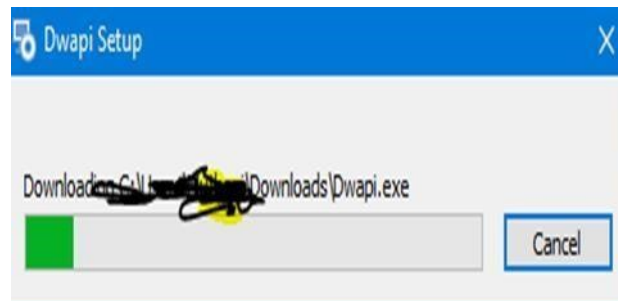

4. **Run DWAPI installation Wizard**



5. Setting up DWAPI

- To access DWAPI, double click on the DWAPI icon on the desktop
- A webpage with the address <http://localhost:5753/#/dashboard> will automatically open on browser at dwapi dashboard page
- Click on Verify Server to confirm connection to the Database Server is established, then Save;
 - a. restart dwapi service,
 - b. refresh browser window, give it a few moments for service to restart
- Click on Verify Database to create a new DWAPI database (you will get 'successful connection to database ok')
 - a. restart dwapi service,
 - b. refresh browser window, give it a few moments for service to restart

This completes setting up DWAPI database connection

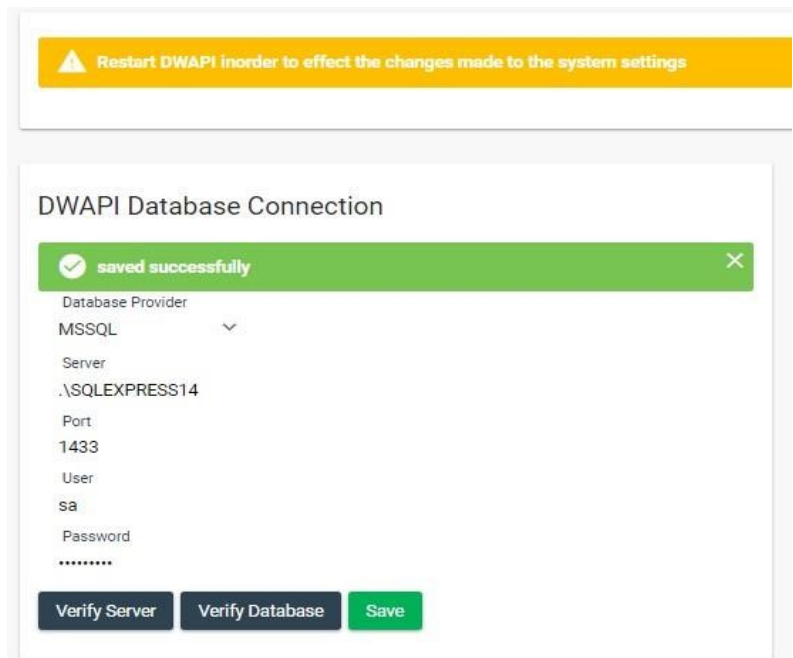

6. Transmission tool set-up and configuration

DWAPI set up and configuration allows for exchange of data between the EMR and National Data Warehouse;

How to configure DWAPI to support EMR:

1. Select Configuration, Click on EMR settings menu,
2. Select the EMR system to connect DWAPI to, IQCare OR KenyaEMR,
3. Under action tab, select Default

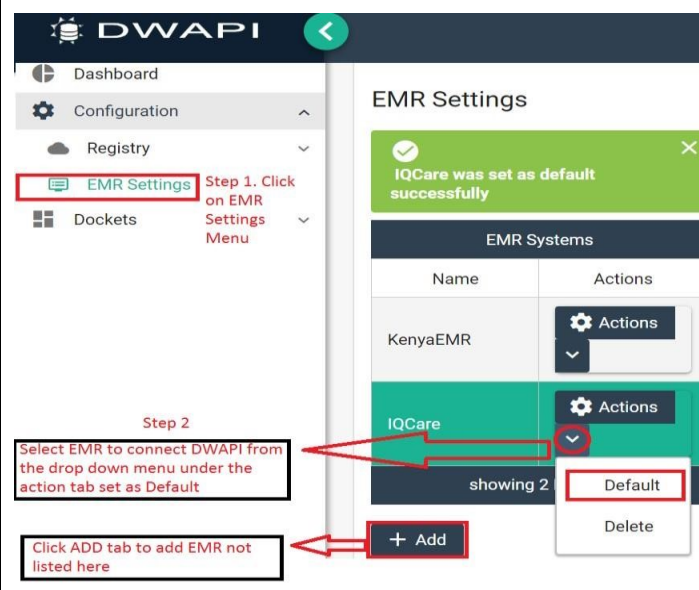

7. **A. Completing EMR configuration for IQCare**

Set the database connection under IQCare protocols

1. Click on edit icon under Action to configure your IQCare database instance
2. On database connection window,
 - a. enter Host name
 - b. enter password
 - c. provide name of database you wish to connect (as they appear in SQL Studio Manager)
 - d. Verify details, and
 - e. Save
3. Repeat step 2 above for IQTools database connection

B. Completing EMR configuration for KenyaEMR

1. Click on edit icon under Action to configure your KenyaEMR database instance
2. On database connection window,
 - a. enter Host name/IP address
 - b. enter password
 - c. provide name of database you wish to connect (as they appear in SQL Studio Manager)
 - d. Verify details, and
 - e. Save

[NOTE: Refer to Job Aid on MySQL Configuration in Ubuntu to complete DWAPI setup for KenyaEMR]

IQCare Protocols

DBMS	Host	Database	Action
MicrosoftSQL	.	IQCare	
MicrosoftSQL	.	IQTools_KeHMIS	

Database Connection **2**

connection was successful

DBMS: Microsoft SQL

Host: .

Port: .

User: sa

Password: .

Database: IQCare

Advanced Properties: .

Save Verify

Database Connection **3 (KenyaEMR)**

connection was successful

DBMS: MySQL

Host: 192.168.1.54

Port: 3306

User: dwapi

Password: .

Database: openmrs

Advanced Properties: Allow User Variables=True

Save Verify

8. Preparing data for transmission
Consists of three steps process of data preparation

1. Data Extraction
2. Data Validation
3. Data Cleaning

Data Extraction (Care & Treatment)

This is the process of loading data from the EMR using 8 file extracts from the EMR;

1. Select Care and Treatment under docket

2. Click Load from EMR on the right menu and wait for the process to complete
3. Click Send to Warehouse.

Repeat a However, if there are records under flagged or rejected, proceed to Data Validation and Data Cleaning above steps for API, HTS docket

Extract	Status	(A) Found	Loaded	(B) Flagged	(C) Rejected	(D) Queued (A-	Sent
ART Patients	Cleared	0	0		0	0	0
Patient Baselines	Cleared	0	0		0	0	0
Patient Labs	Cleared	0	0		0	0	0
Patient Pharmacy	Cleared	0	0		0	0	0
Patient Status	Cleared	0	0		0	0	0
Patient Visits	Cleared	0	0		0	0	0
Patient Adverse E	Cleared	0	0		0	0	0
All Patients	Found	7601	0		0	0	0

9. Data Validation

Once data is loaded from the EMR, validation summary for all extracts will be available on Extract Details section.

Select a file extract and corresponding validation summary to identify records with quality gaps.

Look at Summary column for details of inaccuracy/gap as displayed by DWAPI.

To correct the inconsistency, proceed to update on EMR application

Data Cleaning (Refer to unabridged Data Cleaning Job Aid)

- Click Export to download excel lists of records with quality issues for correction in EMR
- Retrieve each client record and fix the error and save changes
- Load and refresh IQTools again

Extract Details

Extract	Field	Type	Summary	Date Generated	Patient PK	Facility Id	Patient ID
TempPatientArtExtracts	DOB	Logical	DOB greater than StartARTDate	2018-09-10T16:15:06.19	1908	754	4437
TempPatientArtExtracts	StartARTDate	Logical	StartARTDate after last visit date	2018-09-10T16:15:06.383	73505	754	13028-07037
TempPatientArtExtracts	StartARTDate	Logical	StartARTDate before patient registered	2018-09-10T16:15:06.413	71495	754	13028-07003

10. **Transmission of Data to NDWH (Refer to Unabridged Data Transmission Job Aid)**

Steps

1. Confirm that all extracts are loaded as displayed in the status column
2. Verify that data is Queued as displayed in the Queued column

3. Click "Send to Warehouse" tab
Progress will be displayed confirming transmission of data to the data warehouse

The screenshot shows the 'National Data Warehouse | IQCare (Ver. 1)' interface. At the top right, a green notification bar says 'Manifest sent'. Below the header, there are two buttons: 'Load from EMR' and 'Send to Warehouse'. A white arrow points to the 'Send to Warehouse' button. Below the buttons is a table with the following data:

Extract	Status	Found	Loaded	Rejected	Queued	Sent
All Patients	Loaded	4430	4424	6	4424	4424
Patient Status	Loaded	2039	1995	44	1995	1995
ART Patients	Loaded	3525	2053	1472	2053	2053
Patient Baselines	Loaded	6757	4424	2333	4424	4424
Patient Labs	Loaded	54007	53960	47	53960	0
Patient Pharmacy	Loaded	122826	122741	85	122741	0
Patient Visits	Loaded	225467	213154	12313	213154	0

Below the table, a green notification bar says 'load was successful'. At the bottom, a progress bar indicates 'Stage 2 of 2: Sending Extracts, please wait ...'.